

# Agile Monitor Arms

## Assembly Instructions

**Tools Included:** Phillips Screwdriver, Allen Keys (2.5/4/5mm), Wrench



**Single Monitor Arm  
Starts Page 2**



**Dual Monitor Arm  
Starts Page 10**

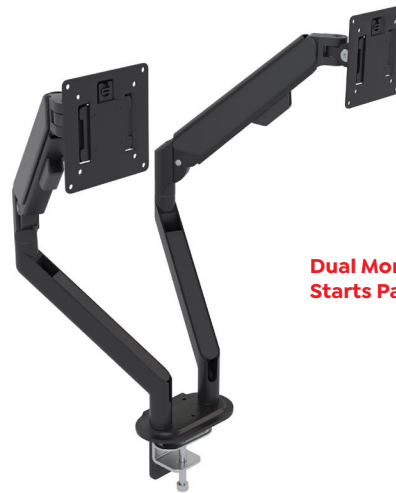

### IMPORTANT NOTES!

Read the entire instruction manual before you start installation and assembly. If you have any questions regarding any of the instructions or warnings, please contact your local distributor for assistance.



**CAUTION:** USE WITH PRODUCTS HEAVIER THAN THE RATED WEIGHTS INDICATED MAY RESULT IN INSTABILITY CAUSING POSSIBLE INJURY.

- Mounts must be attached as specified in assembly instructions. Improper installation may result in damage or serious personal injury.
- Safety gear and proper tools must be used. This product should only be installed by professionals.
- Make sure that the supporting surface will safely support the combined weight of the equipment and all attached hardware and components.
- Use the mounting screws provided and DO NOT OVER TIGHTEN mounting screws.
- This product contains small items that could be a choking hazard if swallowed. Keep these items away from children.
- This product is intended for internal use only. Using this product outdoors could lead to product failure and personal injury.

**IMPORTANT:** ENSURE THAT YOU HAVE RECEIVED ALL PARTS ACCORDING TO THE COMPONENT CHECKLIST PRIOR TO INSTALLATION. IF ANY PARTS ARE MISSING OR FAULTY, TELEPHONE YOUR LOCAL DISTRIBUTOR FOR A REPLACEMENT.

**MAINTENANCE:** CHECK THAT THE BRACKET IS SECURE AND SAFE TO USE AT REGULAR INTERVALS (AT LEAST EVERY THREE MONTHS).

## Assembly Instructions

### Hardware



**A**  
M8x16(x1)



**B**  
M6x10(x2)



**C**  
M5x10(x4)



**D**  
M4x10(x4)

### Tools

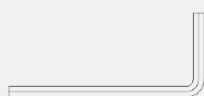

**E**  
2.5mm(x1)

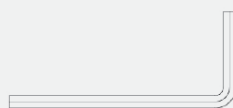

**F**  
4mm(x1)

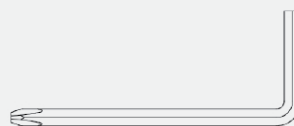

**G**  
5mm(x1)

### Components

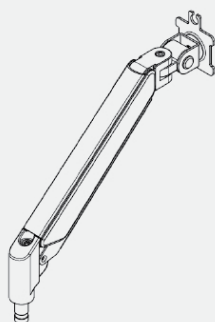

**8 (x1)**

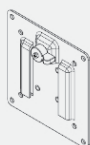

**1 (x1)**

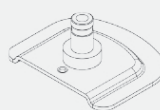

**2 (x1)**

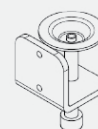

**3 (x1)**

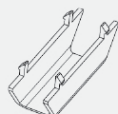

**4 (x1)**

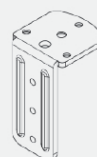

**5 (x1)**



**6 (x1)**

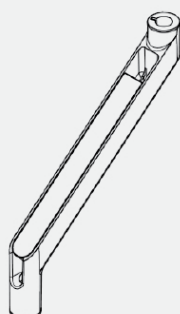

**9 (x1)**



**7 (x1)**

## Step 1 Mounting Option

### Option A: Clamp

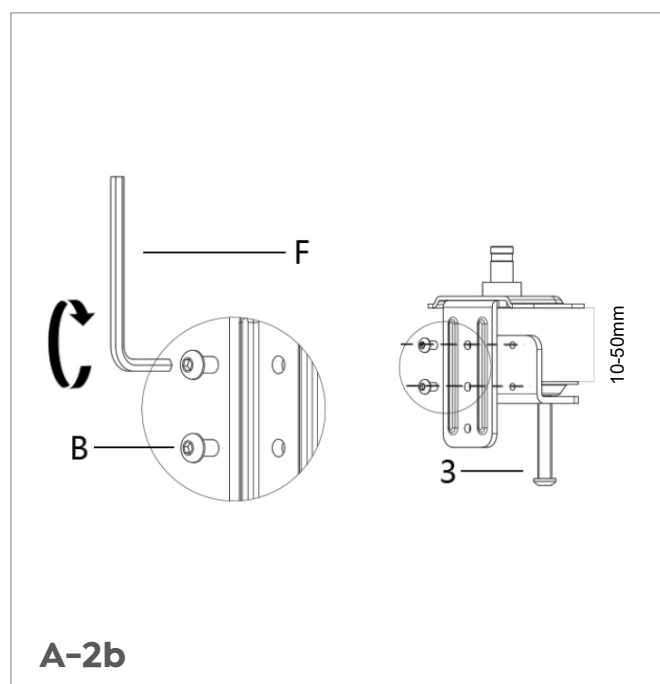
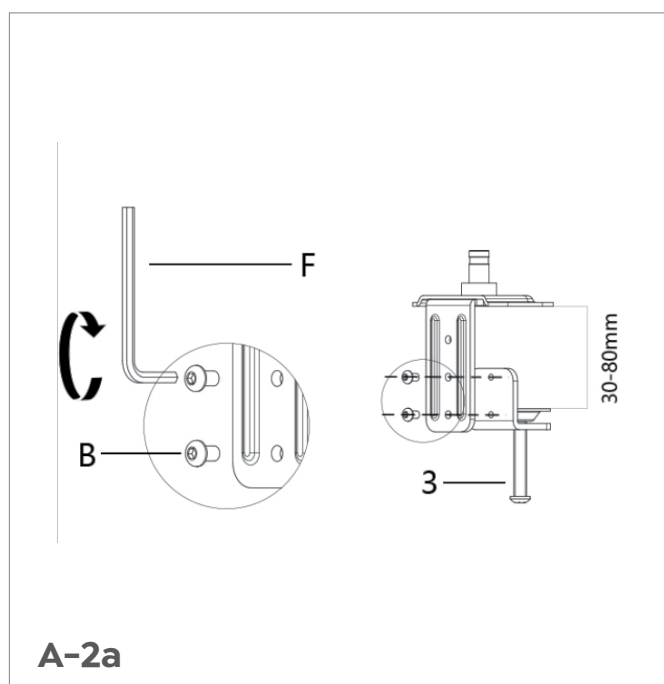
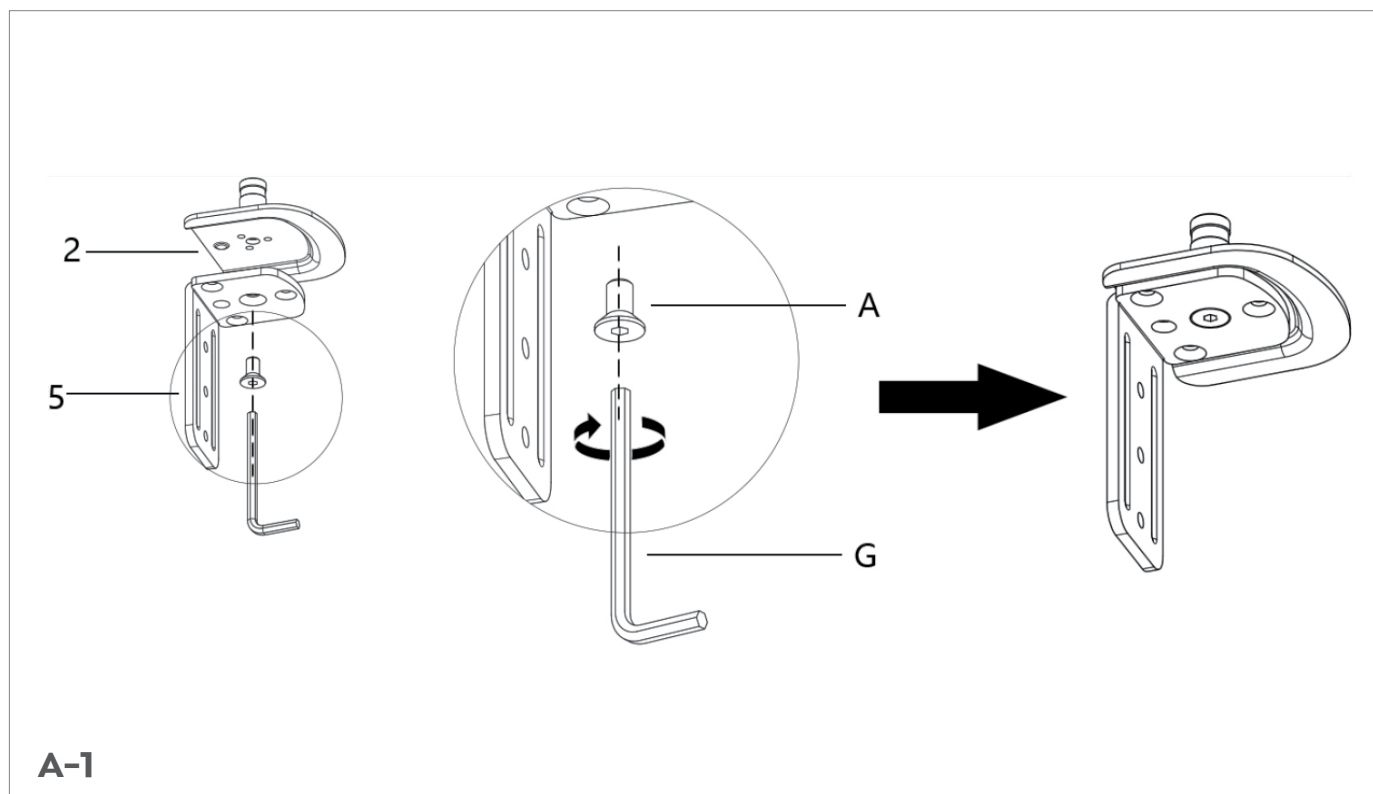

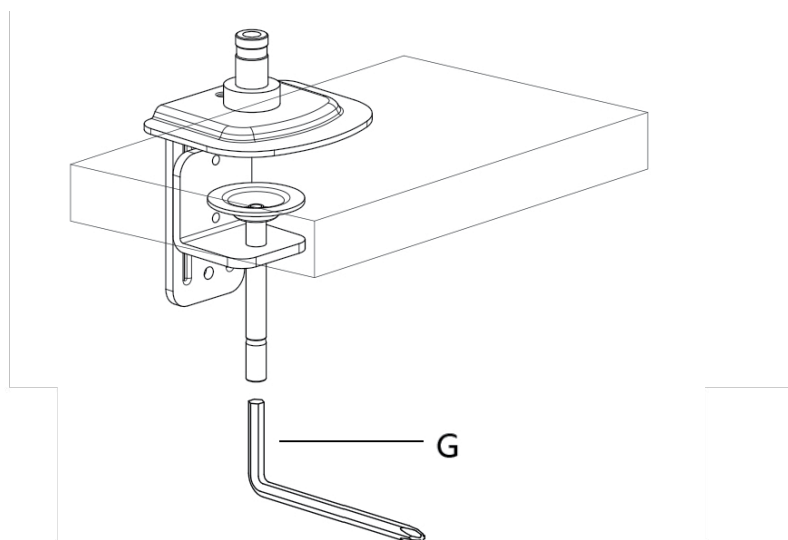

**A-3**

### Option B: Grommet Hole

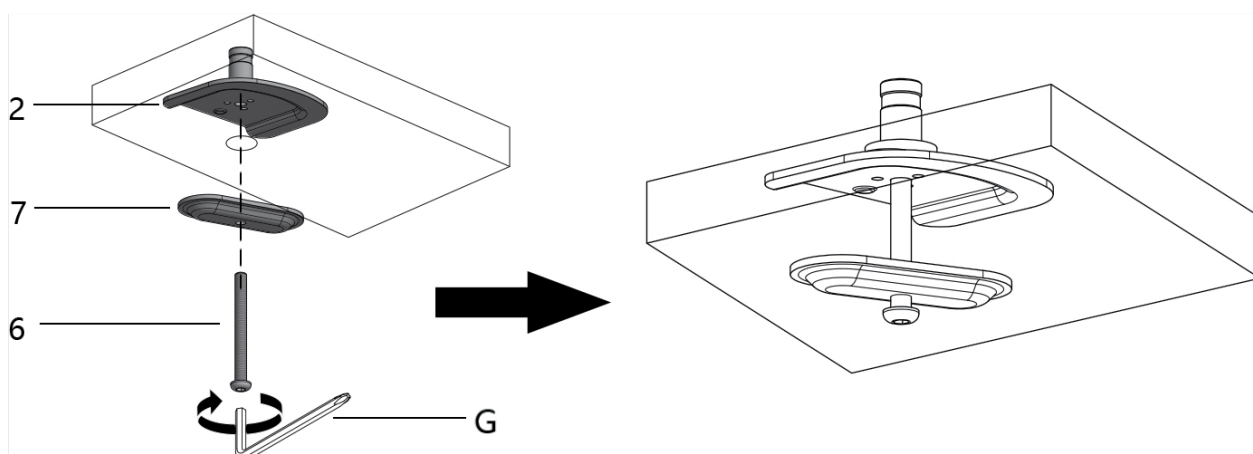

**B-1**

### Step 2 Installing the Arm

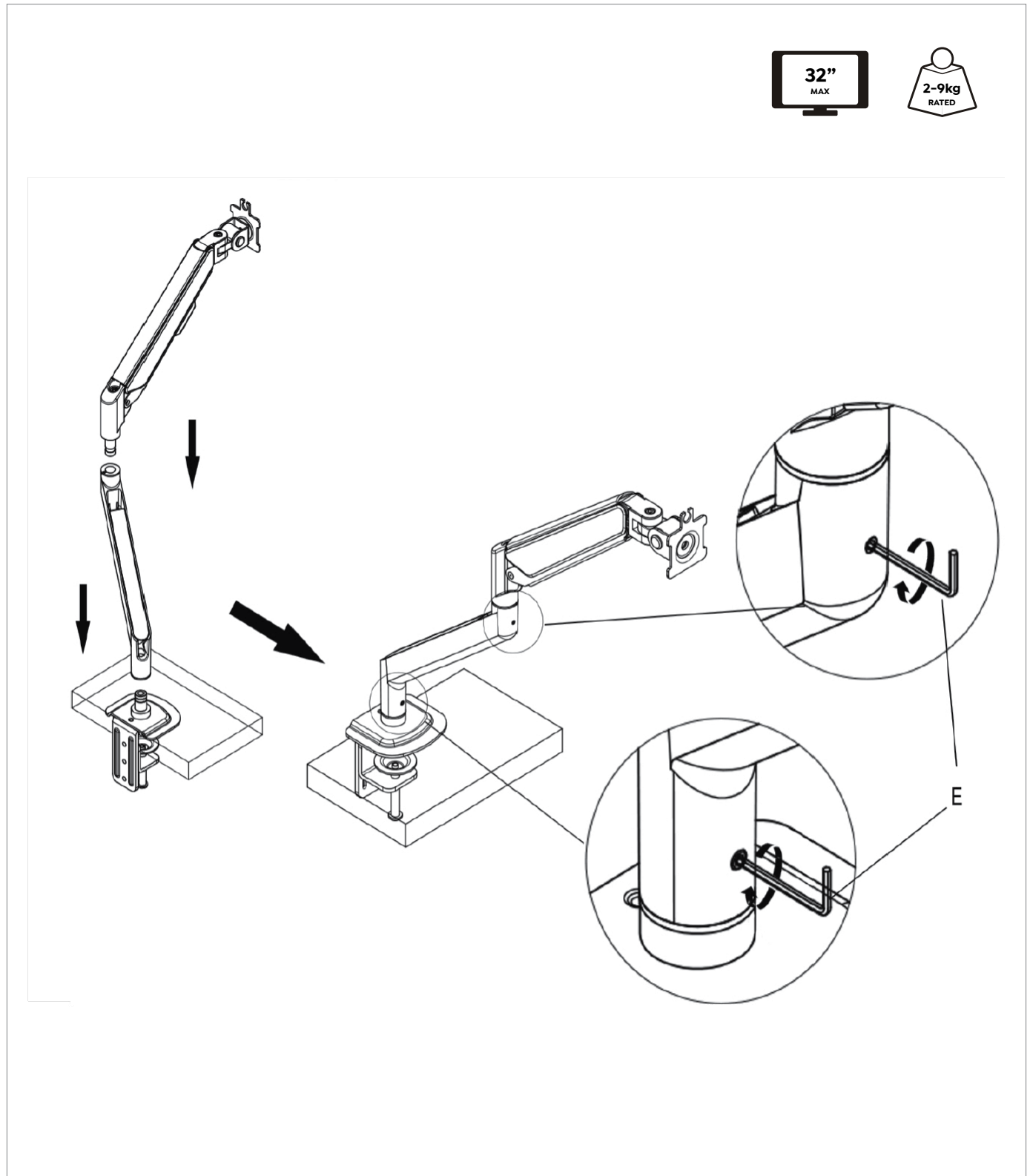

### Step 3 Connect the Monitor

Use a screwdriver (G) to screw the screws (C/D) into the four holes at the back of the monitor. Avoid over-tightening the screws as it may damage the monitor.

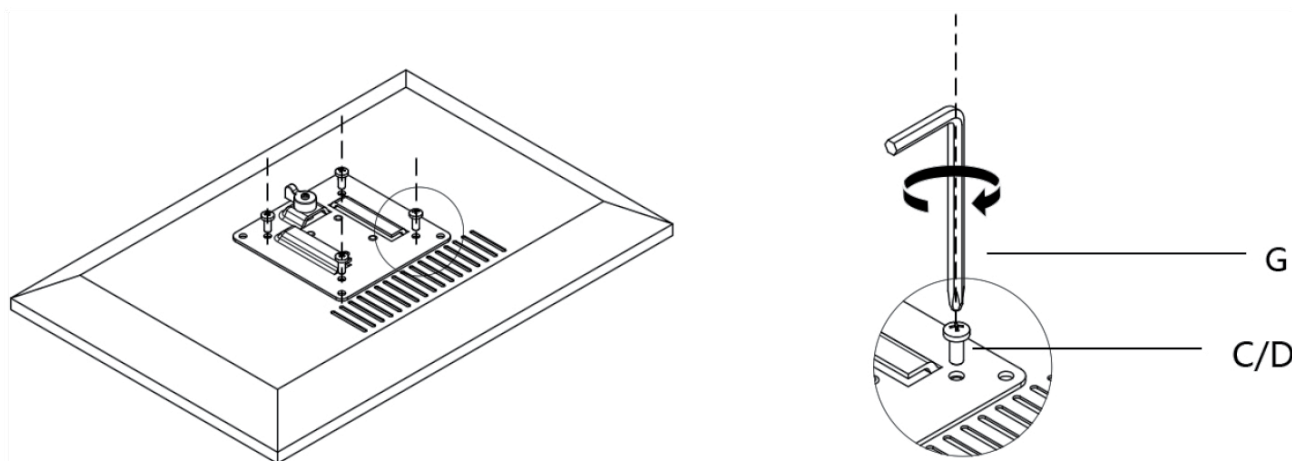

3-1

When the display plate is inserted onto the quick release head, make sure the knob is vertical.

After insertion, rotate the knob 90 degrees to the left.

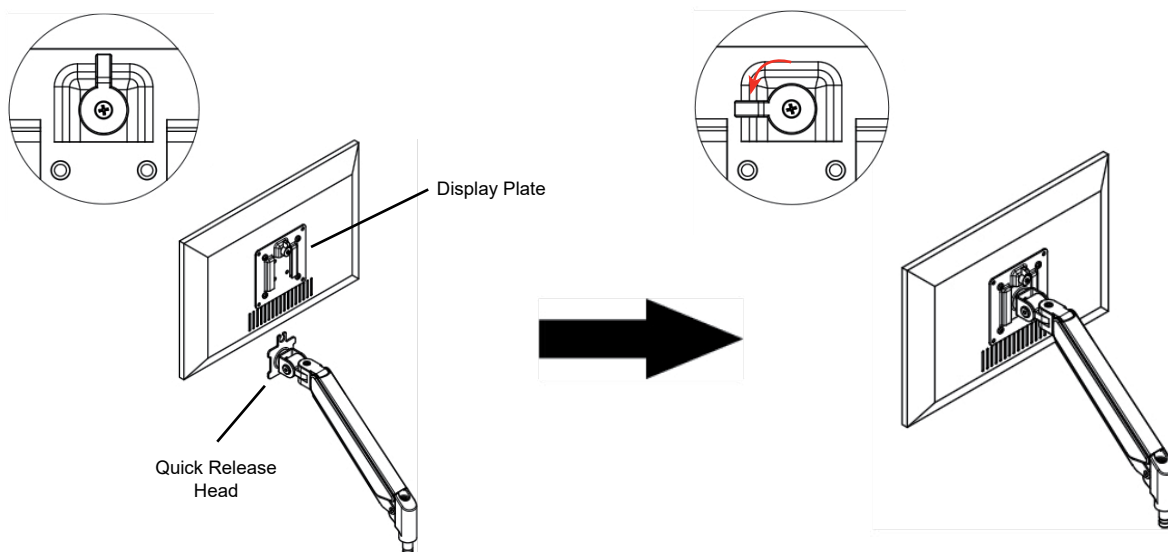

3-2

### Step 4 Tension Adjustment

If the arm sinks after mounting the monitor, use the allen key to adjust the screw on the arm. Turn counter-clockwise ('+' direction) to increase gas spring tension until it can hold the weight of your monitor.

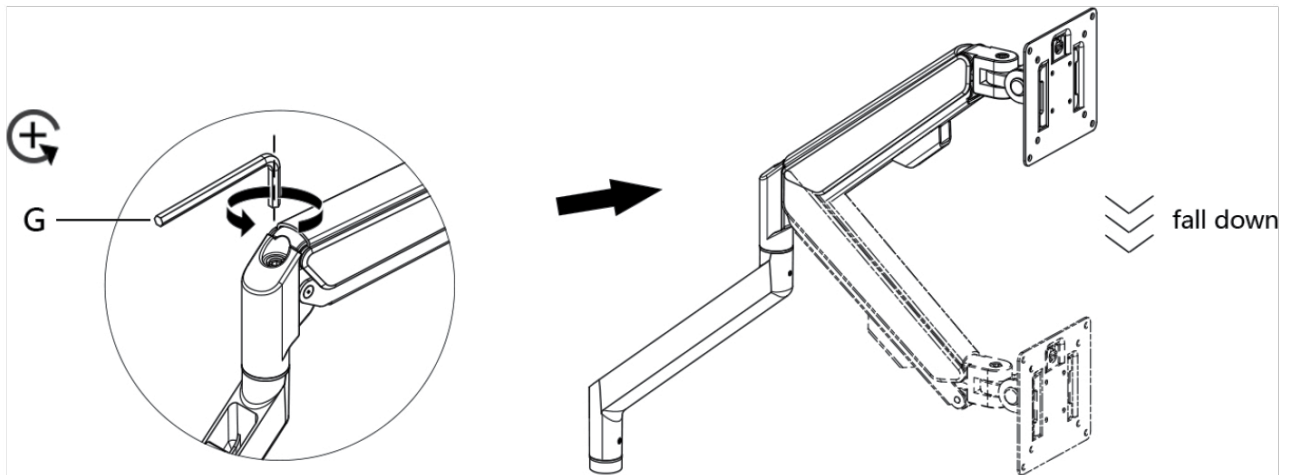

4-1

If the arm can't descend after mounting the monitor, use the allen key to adjust the screw on the arm. Turn clockwise ('-' direction) to reduce gas spring tension until it can stay in the position needed.

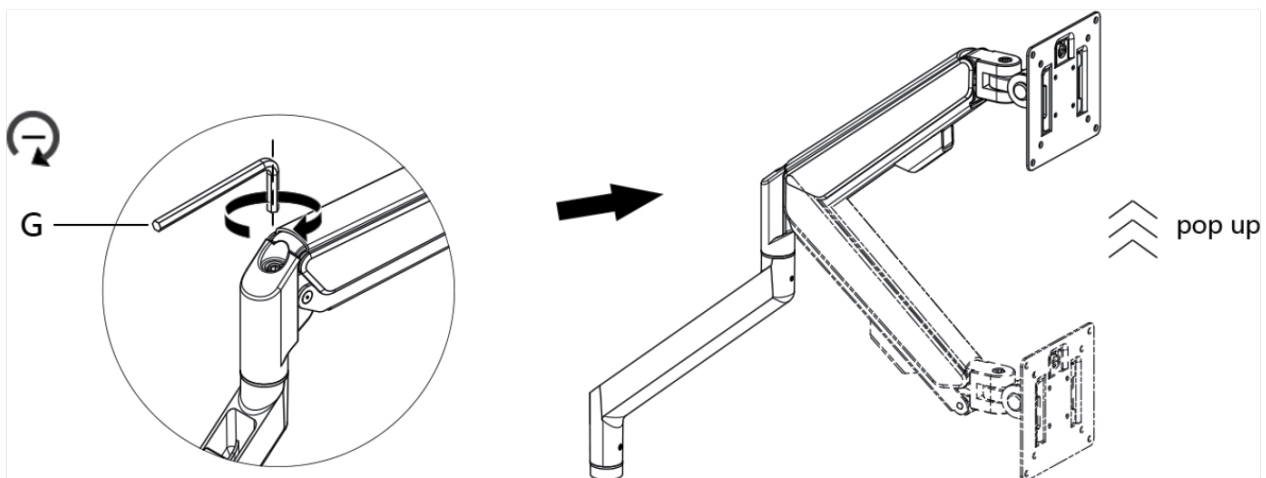

4-2



### Step 5 Leaning Adjustment

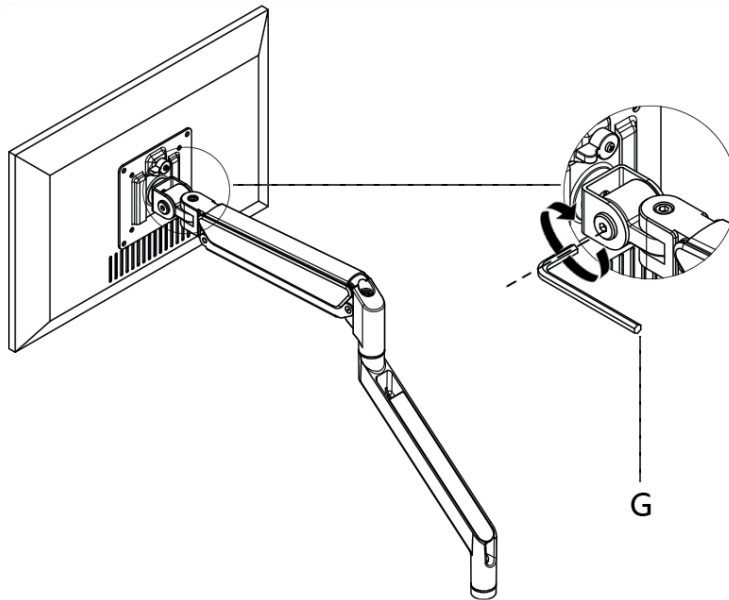

If you feel the pitching angle is too tight or too loose when adjusting the mount, please adjust the screw shown.

### Step 6 Cable Management

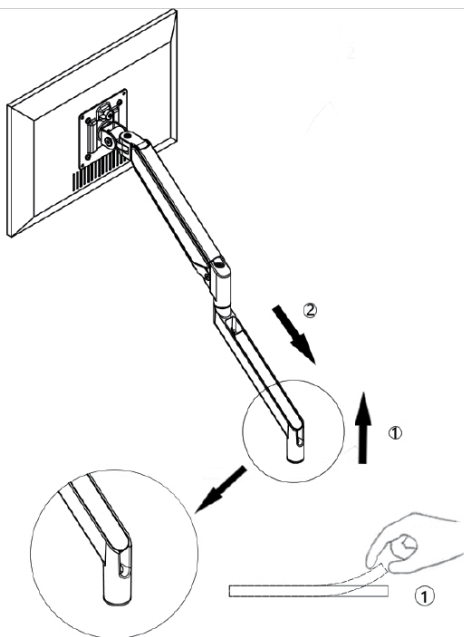

#### As shown:

- 1 - Lift the arm cover slightly out of the lower arm.
- 2 - Then slide the arm cover out.

6-1

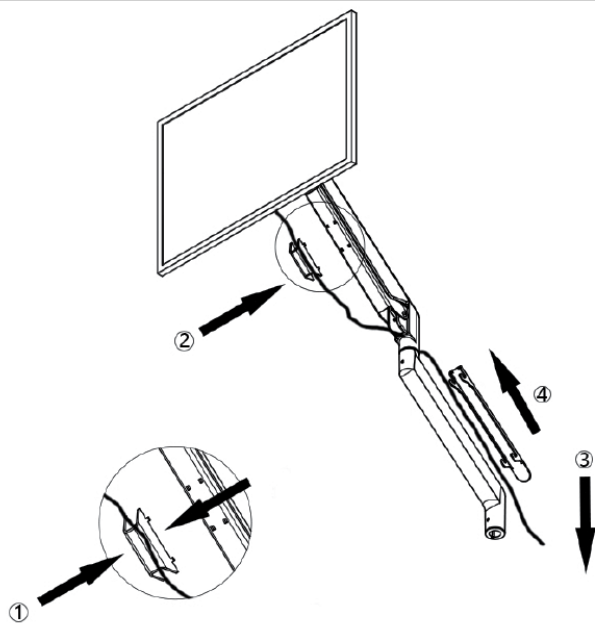

### As shown:

- 1 - Squeeze the arm buckle inward, with cable located in-between.
- 2 - Place arm buckle into the upper arm hole site.
- 3 - Insert cable into lower arm cavity and place the arm cover in position.
- 4 - Slide arm cover upwards to lock into place.

6-2

## Step 7 Arm Adjustment

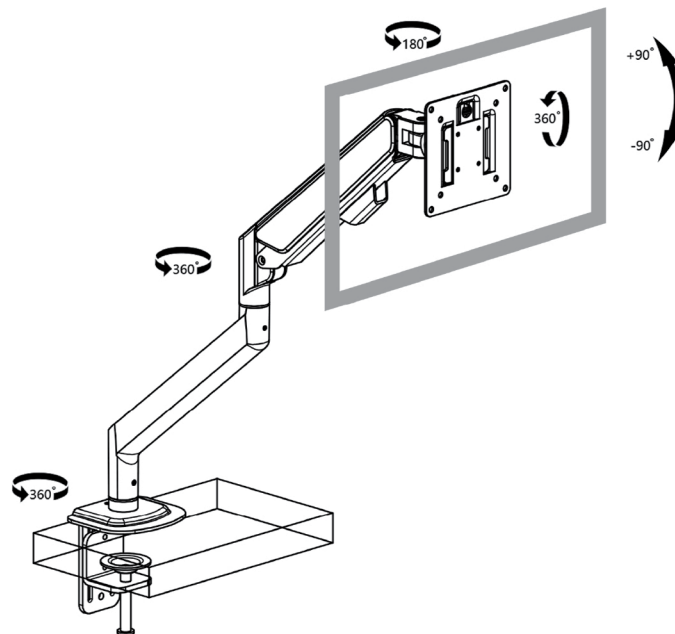

## Assembly Instructions

### Hardware

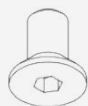

**A**  
M6x9(x3)



**B**  
M6x10(x2)



**C**  
M5x10(x8)



**D**  
M4x10(x8)

### Tools



**E**  
2.5mm(x1)



**F**  
4mm(x1)



**G**  
5mm(x1)



**I**  
14mm(x1)

### Components

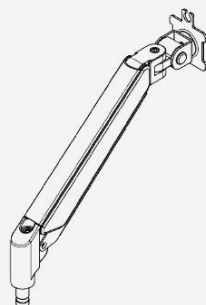

10 (x2)

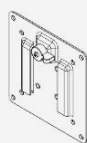

1 (x2)

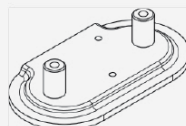

2 (x1)

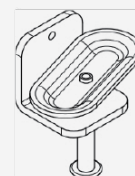

3 (x1)

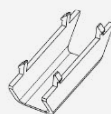

4 (x2)

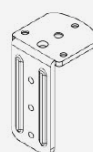

5 (x1)



6 (x1)

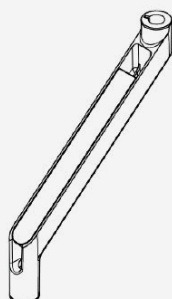

11 (x2)



7 (x1)



8 (x2)



9 (x1)

## Step 1 Mounting Option

### Option A: Clamp

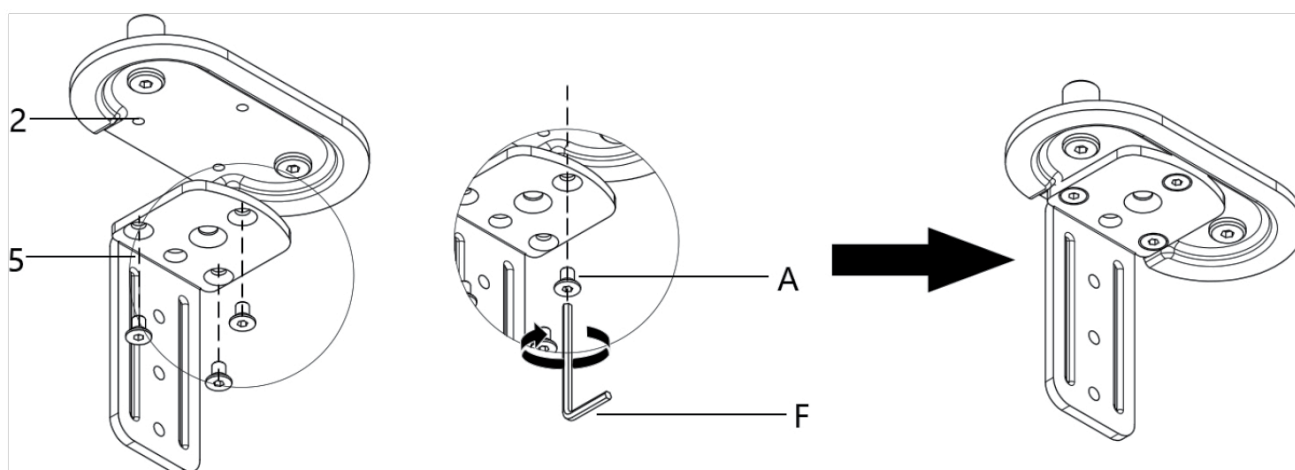

A-1

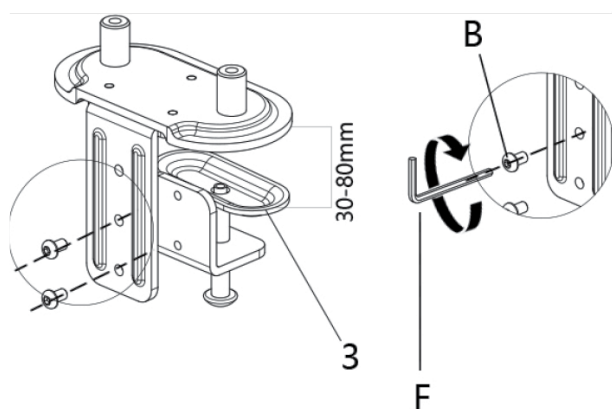

A-2a

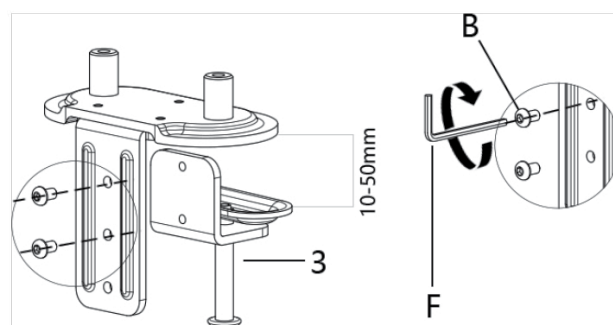

A-2b

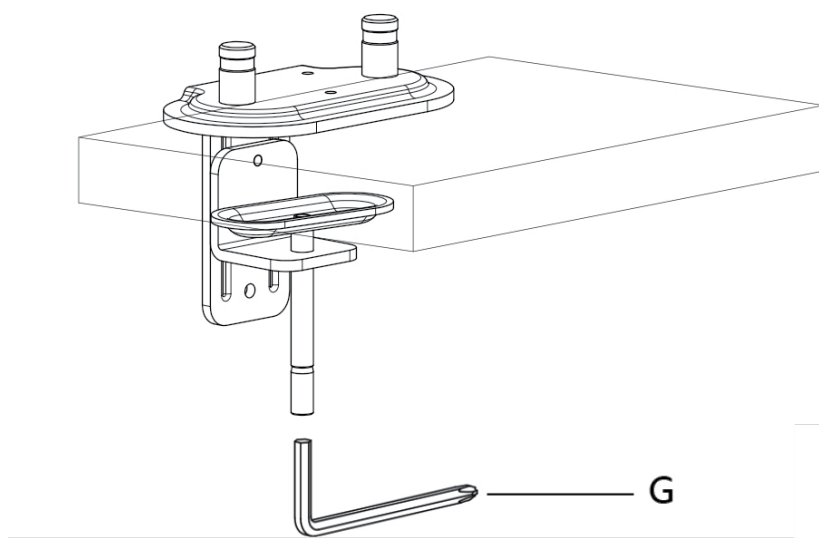

A-3

### Option B: Grommet Hole

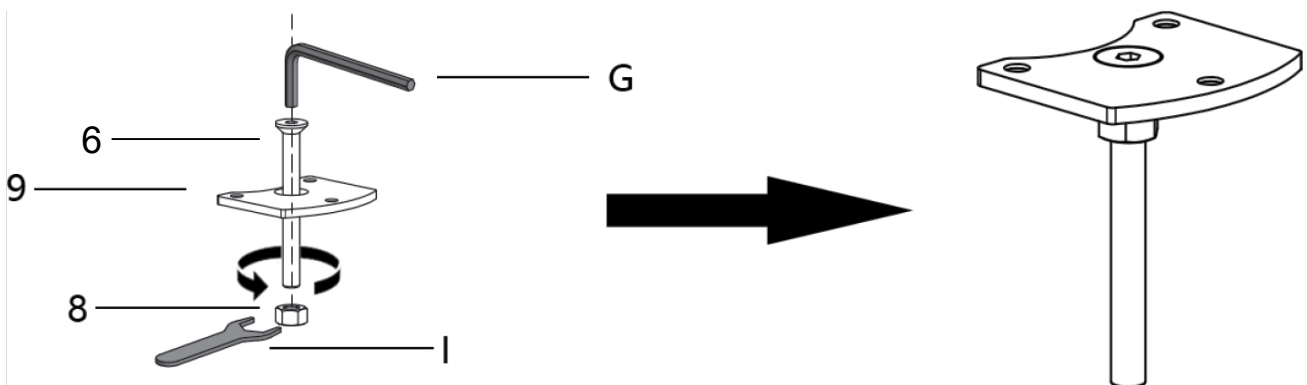

B-1

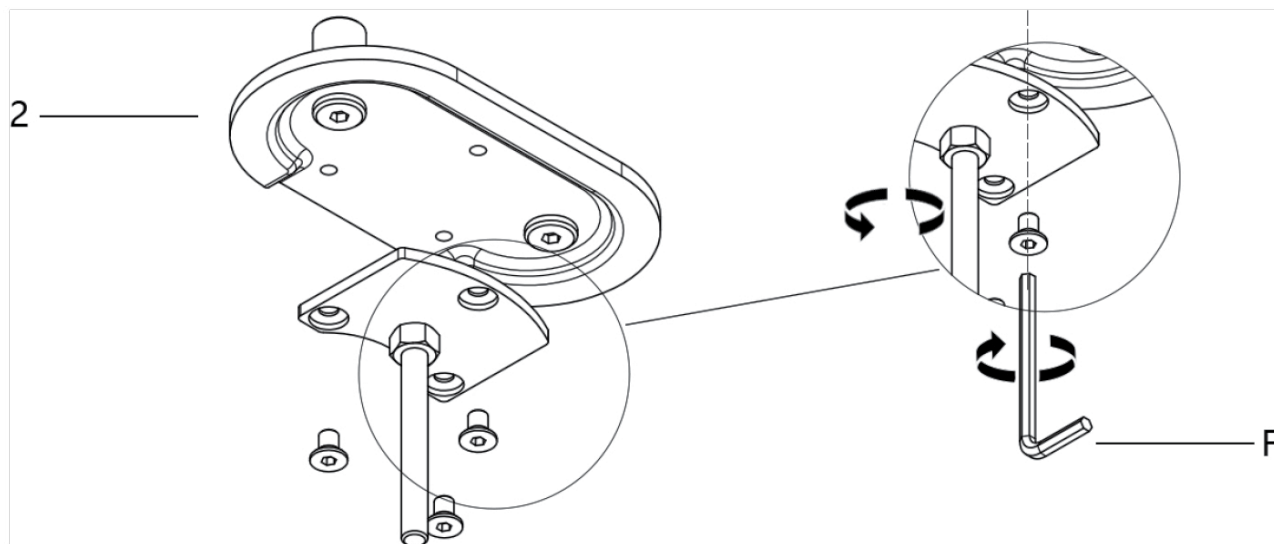

**B-2**

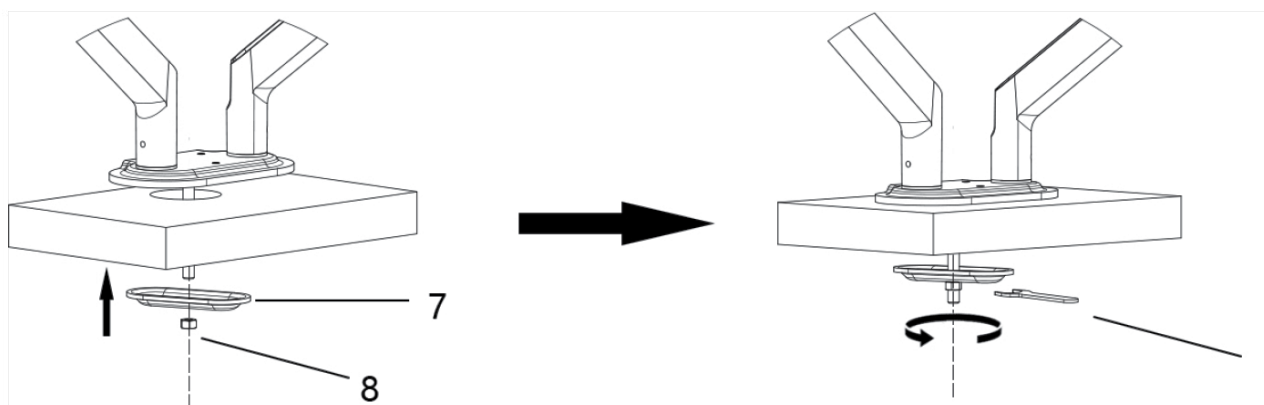

**B-3**

### Step 2 Installing the Arm

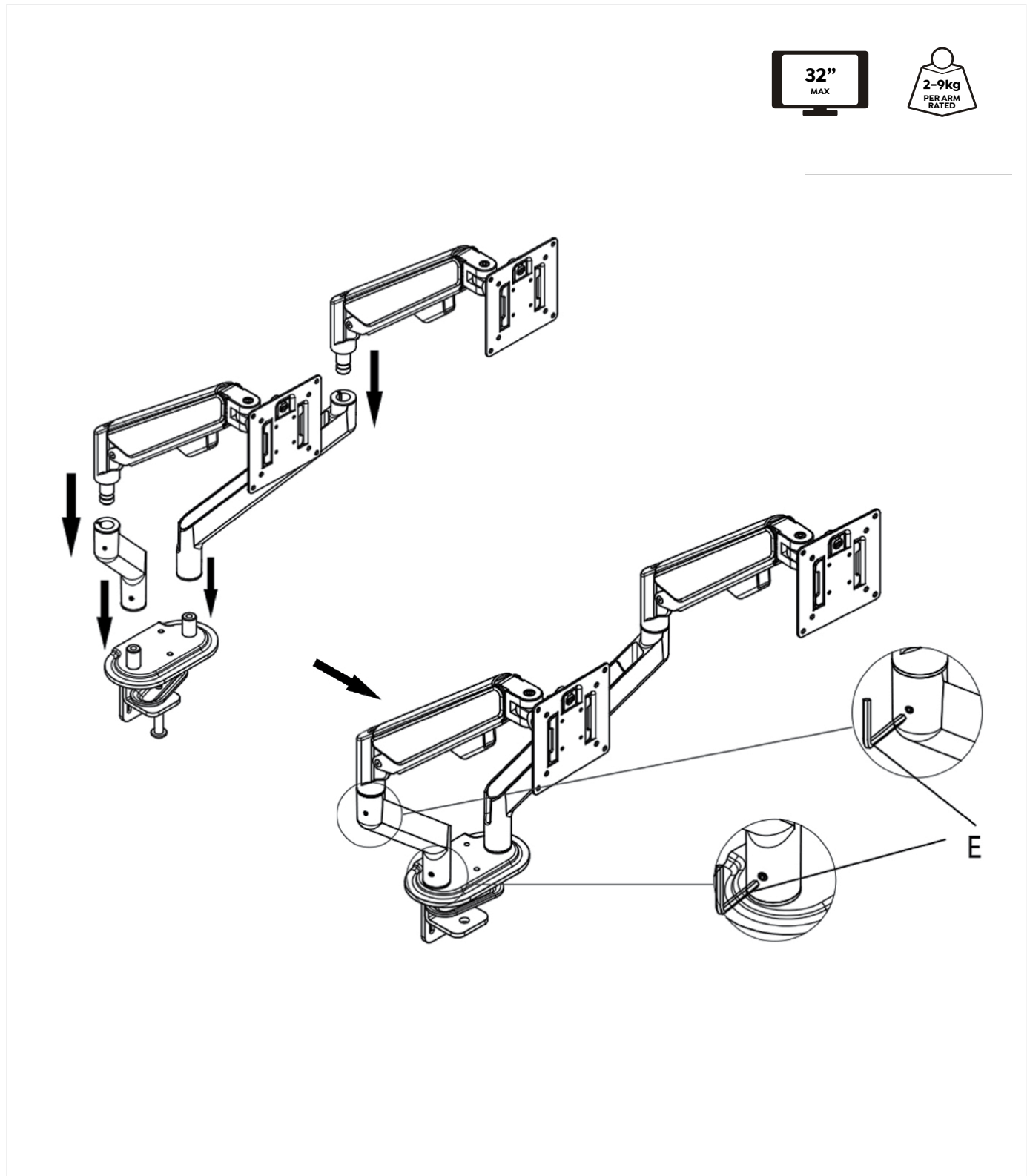

### Step 3 Connect the Monitor

Use a screwdriver (G) to screw the screws (C/D) into the four holes at the back of the monitor. Avoid over-tightening the screws as it may damage the monitor.

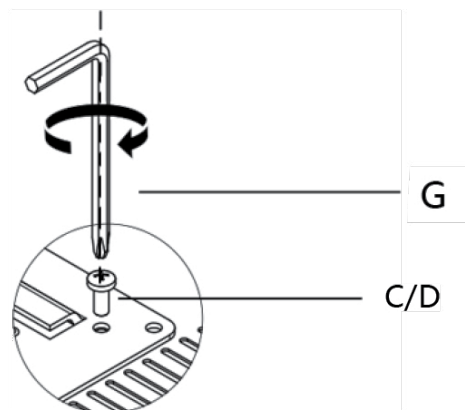
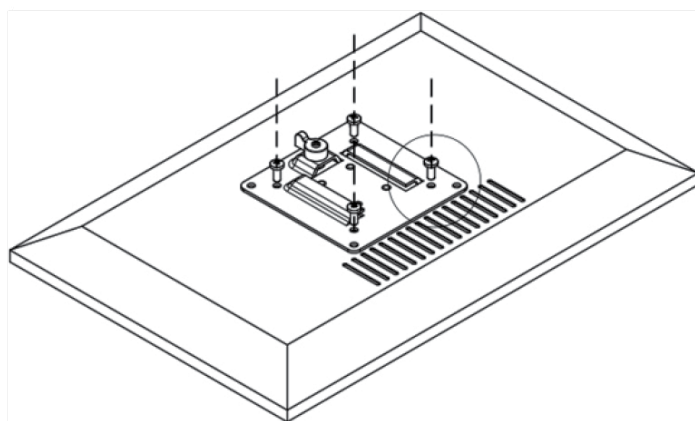

3-1

When the display plate is inserted onto the quick release head, make sure the knob is vertical.

After insertion, rotate the knob 90 degrees to the left.

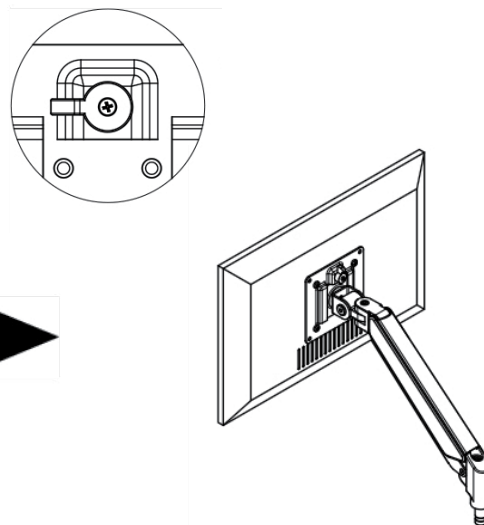
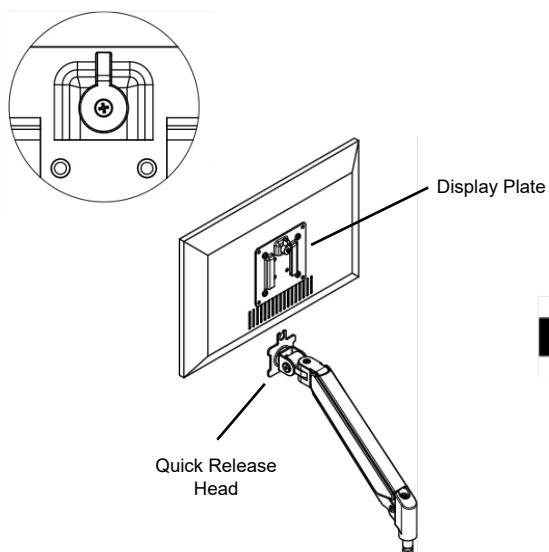

3-2



### Step 4 Tension Adjustment

If the arm sinks after mounting the monitor, use the allen key to adjust the screw on the arm. Turn counter-clockwise ('+' direction) to increase gas spring tension until it can hold the weight of your monitor.

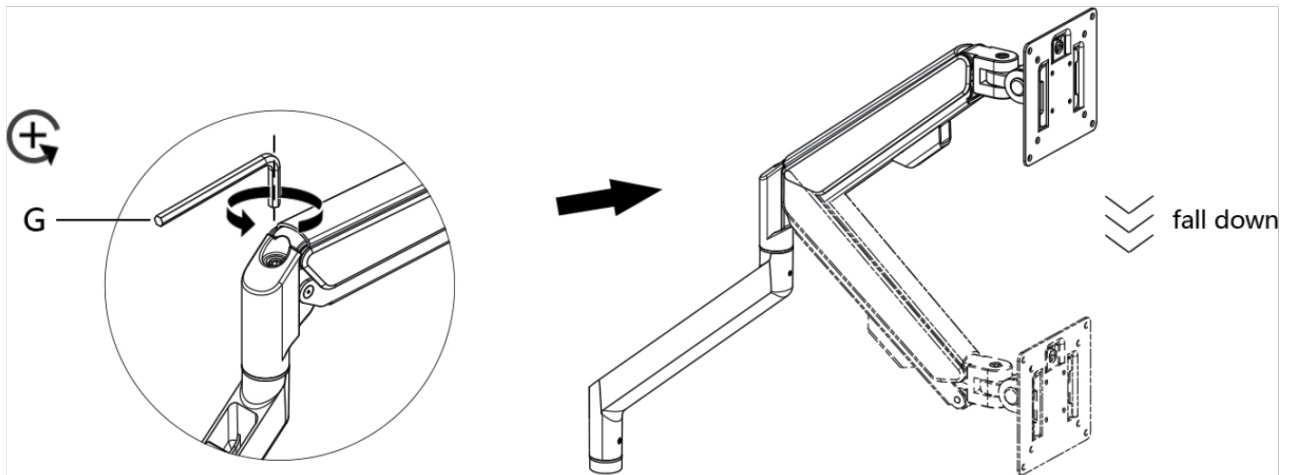

4-1

If the arm can't descend after mounting the monitor, use the allen key to adjust the screw on the arm. Turn clockwise ('-' direction) to reduce gas spring tension until it can stay in the position needed.

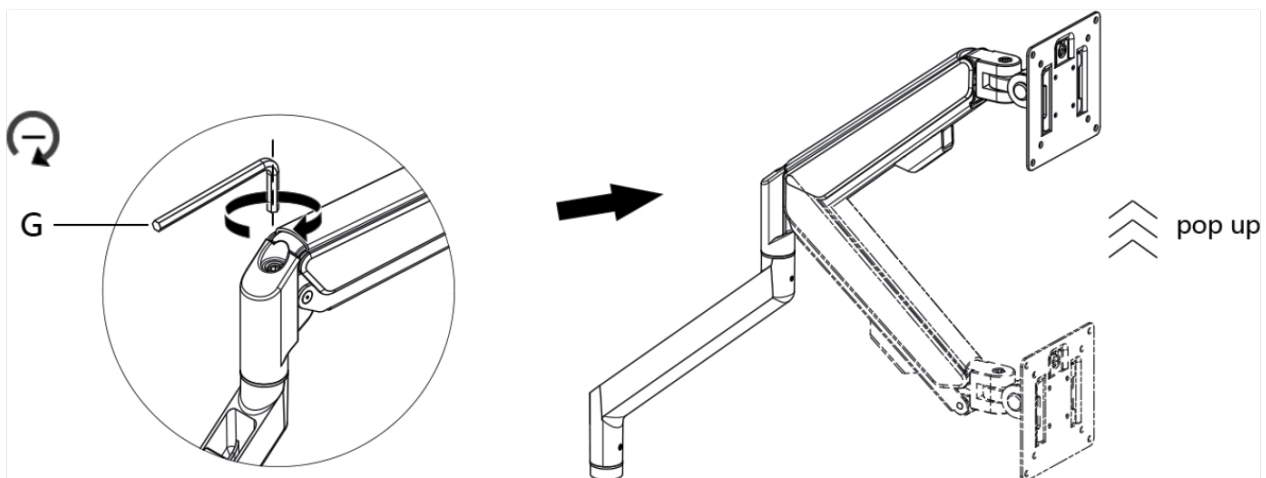

4-2

### Step 5 Leaning Adjustment

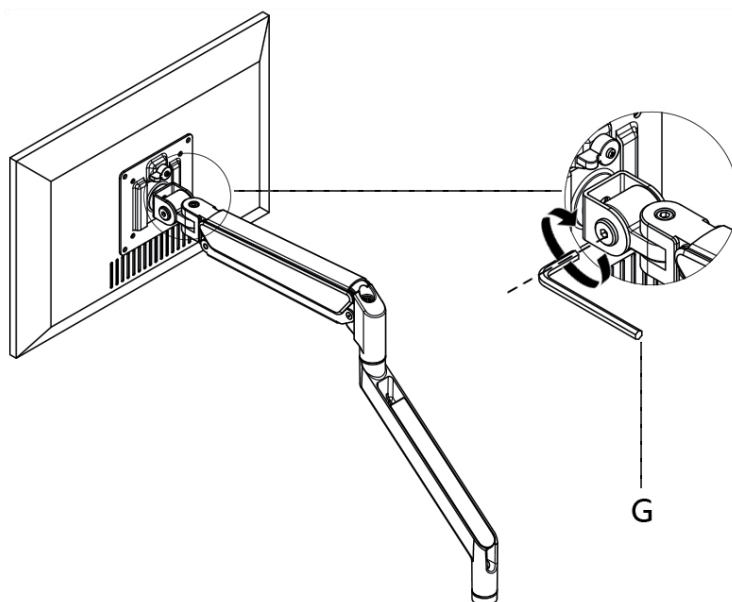

If you feel the pitching angle is too tight or too loose when adjusting the mount, please adjust the screw shown.

### Step 6 Cable Management

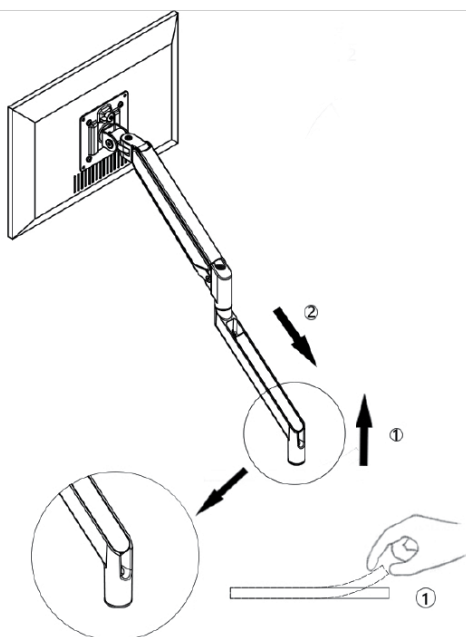

#### As shown:

- 1 - Lift the arm cover slightly out of the lower arm.
- 2 - Then slide the arm cover out.

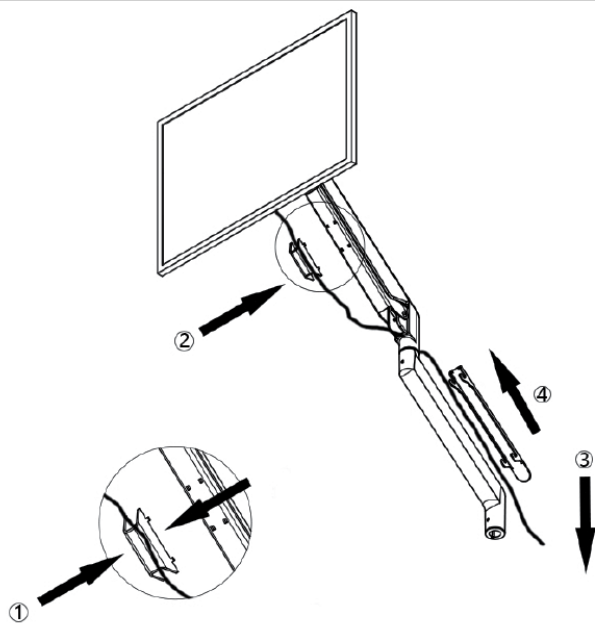

### As shown:

- 1 - Squeeze the arm buckle inward, with cable located in-between.
- 2 - Place arm buckle into the upper arm hole site.
- 3 - Insert cable into lower arm cavity and place the arm cover in position.
- 4 - Slide arm cover upwards to lock into place.

6-2

## Step 7 Arm Adjustment

